

BEAUTIFUL KITCHENS

The Ultimate in Elegance

Rich details that
make the difference

Special
**BEFORE
& AFTER**
Section
p. 21

Surround Yourself in Luxury

Gorgeous Banquettes p. 12
Chef-Caliber Appliances p. 16

SPRING 2010
Display until April 27

\$9.99



KitchenBathIdeas.com

Tailored to Last

Writer: Erin Crawford Photographer: Stacey Brandford



One-of-a-kind detailing makes this classically-styled kitchen an unforgettable master class in millwork design.



Traditional white cabinetry creates a timeless backdrop for the bold walnut island, dressed up with dynamic curves, arched brackets, and a detailed countertop.



Opposite: The Belgian black marble island countertop creates a sophisticated contrast against the statuario marble counters and backsplash. A third stone, crema marfil, was laid in a simple straight pattern on the floor.

Left: Pretty carvings and curved brackets with a spiral detail on the custom wood hood provide a feminine contrast to the richly masculine island. Behind the range, a basketweave mosaic adds artistic interest within the subtle color scheme.

Below: The island countertop is divided into two levels to accommodate eating and prep space.



As the head of a cabinetry company, Guido Doria spends much of his time creating beautiful kitchens. When the time came to build his own, he wanted something timeless yet fresh, something he'd never seen before and would never see again in any kitchen but his own.

"I like traditional styling and classic design," he says. "I wanted something that wasn't going to date."

Collaborating with interior designer Philip Mitchell, of Philip Mitchell Design, they chose elements that could withstand the vagaries of style, then layered on exceptional levels of detail. The subtle twists of trim and design create a rich classicism in a room that's the nucleus of his home, one of his family's primary gathering spaces.

Guido says the layout for the kitchen flowed naturally from the shape of the room and his years of experience. "Having done so many kitchen designs, I knew how the kitchen should work to marry practicality and aesthetics," he says. "What was more difficult was the detailing."

Mitchell and the Dorias focused on traditional European style, executed with a contemporary sensibility. Many of the design choices throughout the home are formal, but creative finishes and details add a freshness and keep the rooms from seeming too serious.

"The cabinetry is an interpretation of a classic framed cabinet," Mitchell says. "We were inspired by the 1940s. You can see the layers and the depth."



Opposite: Choosing extra-thick cabinet doors allowed the design team to add additional layers of intricate knifed details, echoing the triple-edge on the countertops. A sleek built-in coffeemaker integrates beautifully into the room, creating an easy-to-access station that isn't in the cook's work space.

This Page: Inspired by European design, the kitchen utilizes a number of elements that transcend trend—classic marble; molding with crisp, clean lines; and a traditional white finish.





TALKING WITH THE INTERIOR DESIGNER

Philip Mitchell explains how the beautiful elements work together in this classic kitchen.

Beautiful Kitchens: Where did you start the design process on this kitchen?

Philip Mitchell: The homeowners wanted the house to look beautiful yet be practical for their family. They wanted everything designed accordingly and not just to be a showpiece. The rest of the house is more formal, but we wanted to fool with the kitchen's finishes and detailing to give it interest and make it less serious.

BK: Talk about this kitchen's wonderful balance between masculine and feminine elements.

PM: It's a family using the kitchen, so it's a blend, rather than all heavy and ornate or all light and whimsical. It's genderless, even with those whimsical carvings over the hood. The island is masculine, but the leaded glass on the cabinets and the carved vine on the hood add more whimsical, feminine detail.

BK: You mentioned not wanting the kitchen to feel like a showpiece. How did you blend such beautiful elements in a livable way?

PM: The ceiling makes it a bit more human in scale, rather than so high it's ridiculous. We used subtle detail. You almost don't realize it because it's surrounding you everywhere. But when you see the home in a photograph, you see all the different moldings.

Guido wanted molding throughout the house to be elegant, but never fussy, so he opted for clean lines. Using extra-thick cabinet doors, they created a singular design with layers of knifed detail. Other elements, such as the countertops and crown molding, echo the stepped detailing.

To give the island a rich, masculine profile, they chose walnut with a burl veneer on the inlay. Concave curves give the large island a dramatic presence.

"I substantially increased the thickness of the countertop, changing the edge profile and nosing to give it more substance," Guido says.

The design team fashioned the surrounding cabinetry in classic white and added a few feminine notes, such as the



DESIGNER PICKS

Cabinetry: Bellini Custom Cabinetry;
416/787-4799; bellini.ca

Floor, backsplash, mosaics & countertops: Ciot Marble & Granite;
ciot.com

Island light fixture: John Rosselli & Associates; 212/593-2060;
johnrosselliassociates.com

Integrated dishwasher: Miele;
800/463-0260; miele.com

Dining table: Elte Carpet & Home;
888/276-3583; elte.com

**ADDITIONAL RESOURCES
BEGIN ON PAGE 116**

Opposite: An antique alabaster light fixture and a curving wall of windows create a breakfast room that sparkles with light. The crown molding echoes the clean, layered lines of the kitchen millwork. Long, simple curtains in a neutral shade put the emphasis on the French doors, some of which are operable and others fixed.

Right: Leaded glass sparkles above the butler pantry's bar sink, outfitted with a traditionally styled faucet. Another beautiful metal element is the pewter hardware. "We wanted to select something simple but not too simple. The hardware has a nice fluted detail," interior designer Philip Mitchell says.

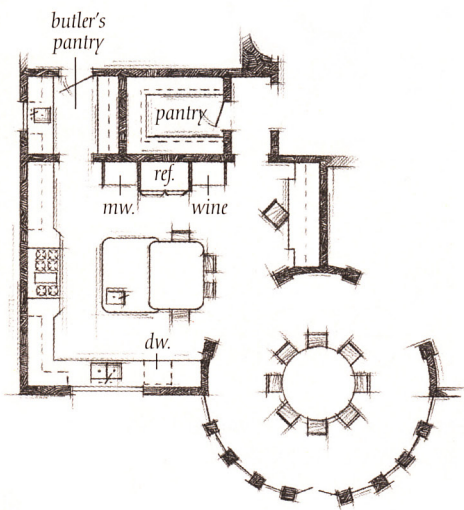

vine adorned carved hood and some leaded glass doors, as pretty complements to the bold island.

"I could have painted the kitchen any color under the sun, but I painted it white," Guido says. "I thought white is classic and I could live with it"

The adjacent breakfast room, overlooking a scenic ravine, functions as an atrium, thanks to a curving wall of windows. Soft gold tones were used in the chairs and curtains to create a glow that spreads into the kitchen.

To support his mission of a timeless sensibility, Guido opted for practical and durable accessories, adding pullouts in nearly every cabinet and cutlery and tray dividers, plus a garbage chute that directs waste directly into the garage.

Some of the custom touches are the sort of subtle flourishes a cabinetmaker would only take trouble to do in his kitchen. For example, a walnut strip along the top of the drawer interiors adds appeal.

"The inside of the cabinets are natural wood, and the dark walnut strip really sets the interior off and gives it an elegant look," Guido says. "That's something you don't normally see in a kitchen."

A more showy custom touch comes in the coffered ceiling, built up using panels and molding. "It had to be planned along with the kitchen, so the positioning of the lighting and bulkheads were in the right spot," Guido says. Like everything else in the house, it's a one-of-a-kind creation.



In Detail

THE REFINEMENT OF TRADITIONAL EUROPEAN STYLE INFLUENCED EVERY CUSTOM DETAIL IN THIS KITCHEN.

CLOCKWISE FROM TOP LEFT: Three layers of carved detail give weight and richness to the white-painted cabinet doors. Simple furniture details, such as a carved arch, enhance the look. • A mix of printed and plain fabrics on the breakfast room chairs brings visual pop to the soft palette of wheat and gold. A velvety leaf pattern adds feminine detail. • The custom ceiling was given unexpected dimension through layers of paneling and molding. • A basket-weave mosaic maintains the kitchen's restrained palette, keeping with the gray-veined marble used in the counters and backsplash. • This unique counter edge, crafted in Belgian black marble, was dreamed up by the homeowner, who owns a cabinetry company and wanted a singular style. • To make the drawers as beautiful inside as out, Guido Doría added strips of richly toned walnut, which contrast beautifully with the natural wood. • This carefully considered island layers on the detail, mixing walnut with burl veneer inlay. Concave curves and arched brackets add drama to the kitchen's stately centerpiece.

